

# WK2/3/4 Keypads, R649 IR Sensor, R615A Cable IR Adapter, IR Remote, HC1 Home Controller

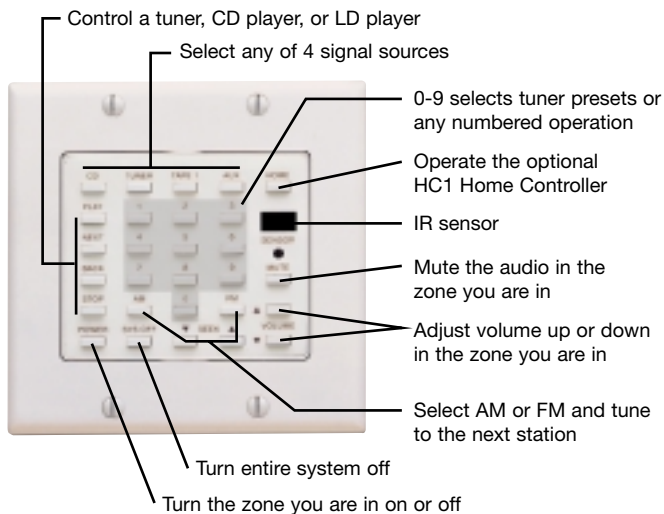

## WK2 Keypad



## FEATURES

The **WK2 Keypad Controller** with built-in IR sensor works with McIntosh Integrated Amplifiers and A/V Control Center/Processors (MX118) that have an F-type sensor input.

- Choose from 4 available A/V sources in a local zone
- Adjust local zone volume level
- Transport controls operate CD players, et al.
- Power off for local zone or entire system
- Use the HOME and number buttons to control devices activated by the optional HC1 Home Controller
- 0-9 buttons select tuner preset, CD track, etc.
- Select AM/FM and tune up/down to the next station

The **WK3 and WK4 Keypad Controllers** have built-in IR sensors and work with McIntosh Multizone A/V Control Centers (CR10, CR12) and A/V Control Center/Processors (MX130, MX132).

- Choose from 5 (WK3) or 8 (WK4) available A/V sources in a local zone
- Adjust local zone volume level
- Illuminated input and power buttons show zone status and selected signal source
- Transport controls operate CD players, et al.
- Select the source and set volume for desired "wakeup" condition when zone is turned on
- Power off for local zone or entire system

## WK3 Keypad

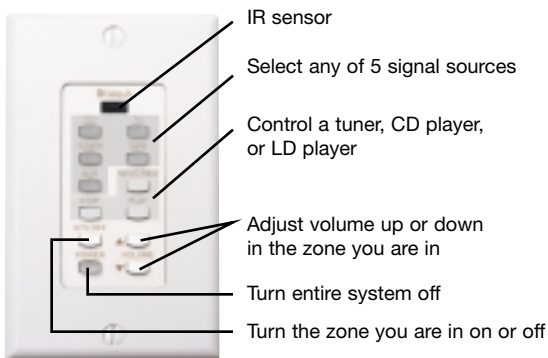

### Additional WK4 Features

- Built-in clock and timer with display showing time of day plus on and off times of scheduled activation
- Sleep mode turns power off after 10 – 60 minutes
- Use the HOME and number buttons to control devices activated by the optional HC1 Home Controller

## WK4 Keypad

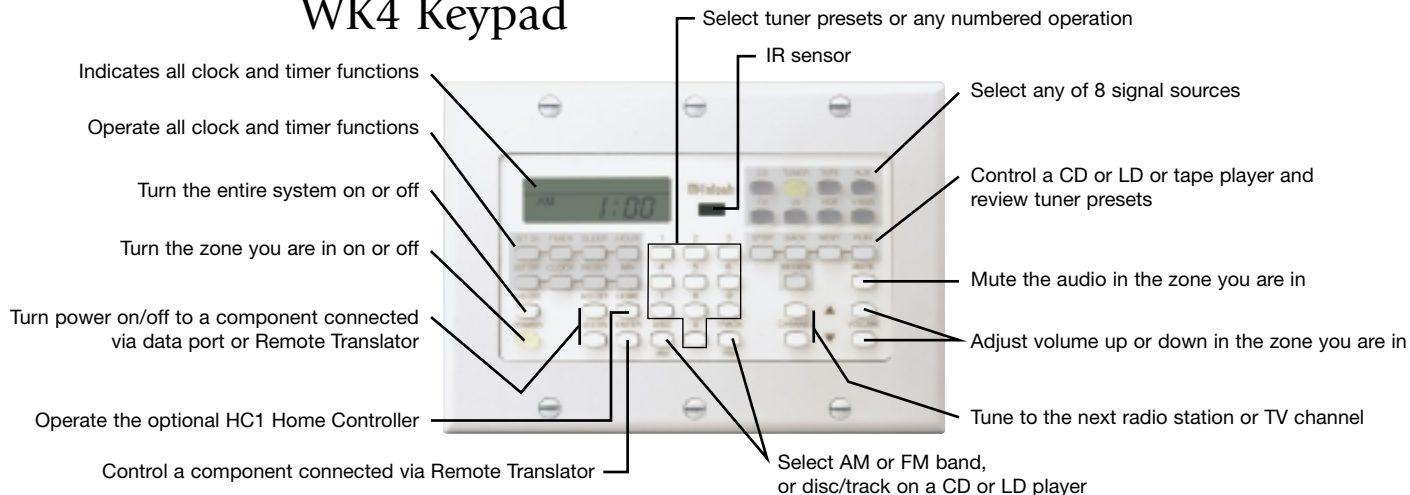

Note: Certain WK4 features pertain only to older McIntosh CD and LD players.

## R649 IR Sensor



## R615A Cable IR Adapter

(Illustration)

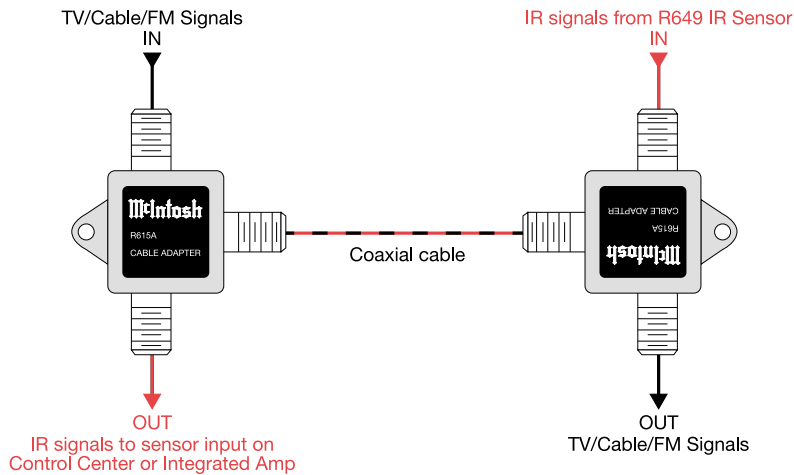

## IR Remote Control



### FEATURES

The **R649 IR Sensor** works with McIntosh Control Centers and Integrated Amplifiers that have an F-type sensor input. It allows IR remote operation from another location.

The **R615A Cable IR Adapter** is a coupling device that allows IR remote signals to be transmitted through common RG-6 or RG-59 coaxial cable (along with TV, cable, and FM signals). Two R615As (one at each end of the cable) as well as one R649 IR Sensor are required.

The **IR Remote Control** operates all Control Centers as well as the MAC3 and MSD4 Surround Decoders.

The **HC1 Home Controller** connects to McIntosh Control Centers and Integrated Amplifiers that include a HOME data port. It can be operated via the numeric keys on a handheld remote or a keypad controller. The HC1 allows the activation of devices such as lights and movie screens to be integrated into a McIntosh system, and is typically set up by a professional installer.

- 6 programmable relays for PUSH ON, PUSH OFF, or MOMENTARY (push and hold) operation
- 3 fixed relays for PUSH ON, PUSH OFF only
- 4 sequenced relays with 0.25-second delay intervals
- Built-in 12VDC/1.5A power supply
- Connections for external 24VDC/1.5A power supply

## HC1 Home Controller

(shown with top panel removed)

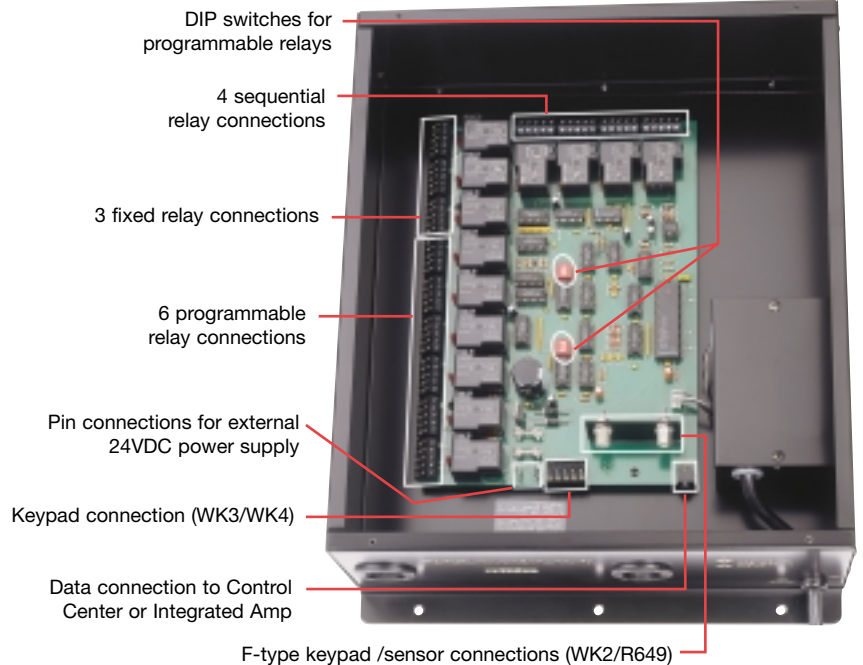

### Related Products

RCT3 Remote Translator



MA6500 Integrated Amp



CR12 Multizone A/V Control Center



MX132 A/V Control Center + Processor

